

Vastu House Rule-01	North	South	East	West	North-East	North-West	South-East	South-West
Structural Positions	North	South	East	West	North East	North West	South East	South West
Kitchen	X	Good	Good	X	☠	X	BEST	X
Staircase	X	Good	X	Good	☠	Good	Good	BEST
Toilet	Ok	Good	X	Good	☠	BEST	Good	X
Boring or U-Ground Tank	Good	X	Good	X	BEST	X	X	☠
Temple	Good	X	Good	Good	BEST	Good	Good	X
Over Head Tank	X	Good	X	BEST	X	X	X	Good
Master Bed-Room	Ok	Good	X	Good	X	X	Good	BEST
Kids Room	X	Good	Good	Good	X	Good	X	Good
Guest Room	Good	X	Good	Good	X	BEST	Good	X
Living Room	Good	X	Good	Good	Good	BEST	Good	X

Vastu House Rule-02

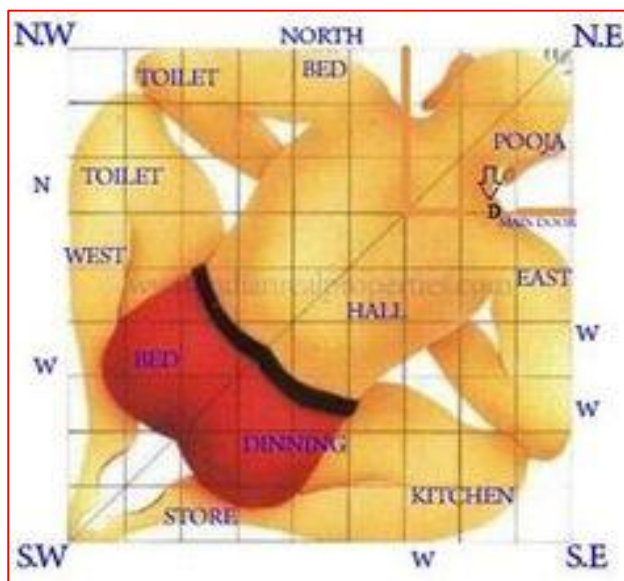

Vastu House Rule-03

North West Granery Toilets Animals Garage Guests	North Treasury Study Room	North East Pooja Verandah Portico
West Children-study	Bramhastan Court-yard	East Dinning Study-room Children Bath
South West Bedroom Dressing Store	South Bedroom Dining	South East Kitchen Garage

Pooja Room for North Facing House

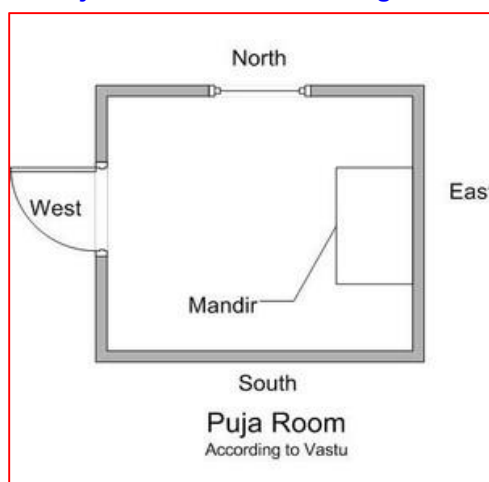

NOTES:

- 1) Master Bed Room should be in South-West Corner
- 2) Kitchen should be in South-East Corner
- 3) God Murti should be West Facing
- 4) God Face should be in Front or Right Side
- 5)
- 6)
- 7) Toilets should Only be in NW or W or in S. It should Not be in any Other Direction. Toilets are Negative in SE, E, N & NE Directions. NE Toilet is Very Serious.
Remedy for Toilet in SE- Use Ocean Salt in Wall & Floor
- 8) No Toilet should be Upon / Below Kitchen or Bedroom
- 9) No Kitchen or Bedroom should be Upon / Below Toilet
- 10) Kitchen & Toilet Wall should Not be Common
Use Hollow Bricks if Kitchen & Toilet Walls are Common
- 11) Kitchen or Pantry should be in SE or if Not Possible then in NW